

# PPPC Valve Seats

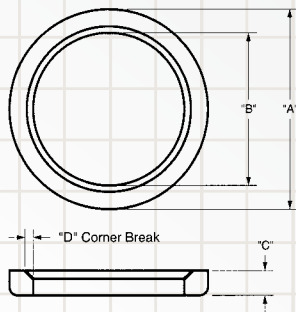

The right metal for the right job.

AMPCO alloy bronze seats—provide an alternative to the beryllium copper seats commonly used in racing today. The high thermal conductivity and wear resistance offer excellent seat performance. Cast Iron seats are heat treated 38-42R.

All PPPC valve seats are available in custom materials and sizes. Call us and give us the dimensions and specifications you need.



## Beryllium Copper Seats

NEW! Made to order Beryllium Valve seats, from certified CDA 17200 are superior to all other seat materials for heat conductivity and longevity. Primarily for aluminum & titanium heads. We use the purest electrode copper & beryllium copper master alloy, which is the finest available. It contains no industrial scrap, is impeccably clean, and very fine grained.

### Cast Iron Intake

Part #	O.D.	I.D.	Depth
2200-2 IS	2.200"	1.810"	.375"
2210-2 IS	2.210"	1.810"	.375"
2250-1 IS	2.250"	1.650"	.400"
2260-3 IS	2.260"	1.810"	.400"
2270-2 IS	2.270"	1.810"	.375"

### Bronze Intake

Part #	O.D.	I.D.	Depth
2200-2 ISC	2.200"	1.810"	.400"
2250-2 ISC	2.250"	1.810"	.400"
2260-2 ISC	2.260"	1.810"	.400"

### Cast Iron Exhaust

Part #	O.D.	I.D.	Depth
1670 ES	1.670"	1.350"	.375"
1670-3 ES	1.670"	1.350"	.400"
1690 ES	1.690"	1.350"	.375"
1700 ES	1.700"	1.350"	.375"

### Bronze Exhaust

Part #	O.D.	I.D.	Depth
1650 ESC	1.650"	1.350"	.400"
1670 ESC	1.670"	1.350"	.400"
1670-2 ESC	1.670"	1.350"	.375"
1680 ESC	1.680"	1.350"	.400"
1690 ESC	1.690"	1.350"	.400"
1700 ESC	1.700"	1.350"	.400"

# PPPC Valve Spring Shims

Part #	O.D.	I.D.	Thickness
03-1915	1.510"	.760"	.015"
03-1920	1.510"	.760"	.020"
03-1930	1.510"	.760"	.030"
03-1950	1.510"	.760"	.050"
03-1960	1.510"	.760"	.060"
03-2015	1.480"	.700"	.015"
03-2020	1.480"	.700"	.020"
03-2030	1.480"	.700"	.030"
03-2050	1.480"	.700"	.050"
03-2060	1.480"	.700"	.060"
03-2115	1.510"	.570"	.015"
03-2120	1.510"	.570"	.020"
03-2130	1.510"	.570"	.030"
03-2150	1.510"	.570"	.050"
03-2160	1.510"	.570"	.060"